

Introduction

Congratulations on choosing the OmiTire hand-held diagnostic tester. The OmiTire has been specifically designed to program the vehicle's control module to register a new tyre pressure monitoring valve, or re-register valves if wheels have been moved into different positions.

This Quick Start Guide will outline the components of OmiTire and how to connect and use the tester.

Overview

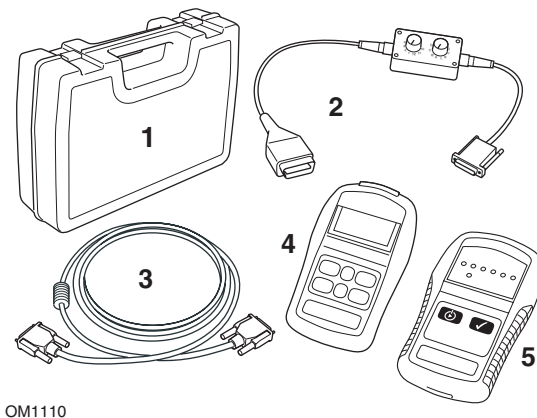

OM1110

The kit includes:

1. Carry case.
2. Switchable J1962 cable.
3. Extension cable.
4. OmiTire Hand-held tester.
5. OmiDetect.

Keypad

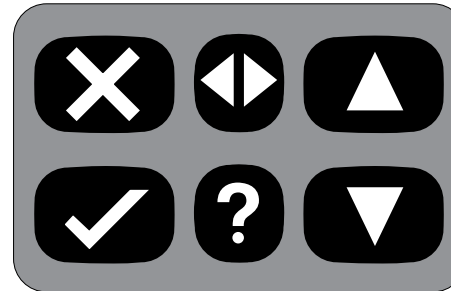

OM0941

The hand-held tester is operated via the 6-button keypad.

The table below details the keypad buttons and their functionality.

Key	Function
✓	Select a menu option, Continue or Yes.
✗	Exit a menu or No.
▲	Scroll up within a menu or text.
▼	Scroll down within a menu or text.
◀▶	Scroll left and right.
?	Provide context sensitive help (where available).

Using OmiTire

Connection

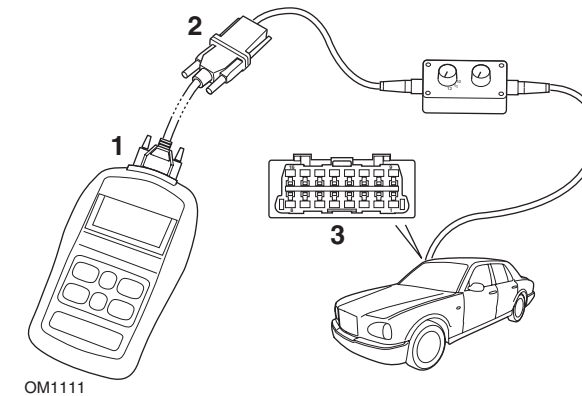

OM1111

1. Connect the extension cable to the hand-held tester, and secure the fixing screws.
2. Connect the extension cable to the switchable harness.
3. Connect the J1962 plug on the switchable harness to the vehicle's diagnostic socket.

This socket is usually located inside the passenger compartment in the vicinity of the driver's footwell. Refer to vehicle manufacturer's information for the exact location.

Note: Power for the hand-held tester is provided by the diagnostic socket.

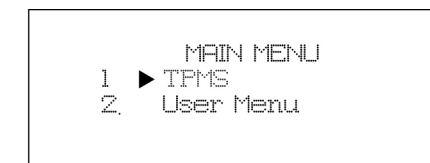

OM1108

When connected to the diagnostic socket, the hand-held tester will perform an internal self test and then the screen will display the date of the current software version before displaying the main menu.

Operation

Use the ▲ and ▼ keys to select the required function.

Press ✓ to confirm the selection.

Press ✕ to return to previous screen or abort programming procedure.

1. Select required manufacturer from list.
2. Follow on-screen instructions.
3. When prompted, activate required Tyre Pressure Monitoring System (TPMS) valve using OmiDetect. See OmiDetect Operating Instructions for details.
4. When each valve code has been programmed, a confirmation message will appear on the hand-held tester. Press the ✓ key to continue.

Renault Application

The Renault application offers further functionality of the hand-held tester, which includes the ability to program valves individually and manually enter known valve codes without requiring OmiDetect.

The additional available menu options are shown below.

Read DTCs

This option allows any 'Stored' or 'Pending' DTCs (Diagnostic Trouble Codes) to be viewed.

If more than one DTC is displayed, the required DTC can be selected by using the ▲ and ▼ keys. Press ✓ to select the DTC and display the description of the code.

Clear DTCs

This option will clear all 'Stored' and 'Pending' DTCs held by the TPMS control module.

Live Data

This option allows the user to view the current status of the TPMS components on the vehicle and can provide a quick way of telling if a component is working correctly.

ECM Data

This option allows the user to view the current ECM data, including: Serial Number and Software Version Number.

Commands

The following options are available under the **Commands** menu:

- Program Valves
- Set Summer Tyres
- Set Winter Tyres
- Set With TPMS
- Set Without TPMS
- Set Pressures
- Change Trigger Limit
- Actuators
- Set Tyre Suffix

TPMS Troubleshooting Tips

If a valve appears to not respond when excited, check the following:

- The tyre valve is a TPMS valve.
- The exciter is not pointing directly at the valve stem.
The valve stem is metal and will prevent a good RF signal. On low profile tyres, the area for the RF to penetrate the tyre sidewall is small, carefully aim OmiDetect half-way between the tyre rim and the tread.
- Check the batteries are not low in the OmiDetect and the TPMS valve.

If there is no response from the valve after the checks have been made, the TPMS valve could be faulty.

Omitec

OmiTire



Operating Instructions

Omitec

Hopton Industrial Estate, London Road, Devizes
Wiltshire, SN10 2EU, United Kingdom

Tel: +44 (0) 1380 732000 Fax: +44 (0) 1380 732001
email: sales@omitec.com

I314409en(1)

Omitec

www.omitec.com

Modular Integrated Diagnostics